

SERVICE

Per assistenza, rivolgetevi alle stazioni di servizio autorizzate Lombardini. N. tel. su libro verde 800-010000. Per vendite e riparazioni, rivolgetevi alle stazioni di servizio autorizzate. Indicare il tipo di motore e la categoria del prodotto. Per assistenza, wenden Sie sich an die autorisierten Lombardini-Service-Center. Telefonnummern sind im Telefonbuch unter der Rubrik "Lombardini" zu finden. Para asistencia, dirija-se a las estaciones de servicio autorizadas Lombardini. N.º de teléfono verde 800-010000. Para ventas y reparaciones, dirija-se a las estaciones de servicio autorizadas. Indicar el tipo de motor y la categoría del producto.

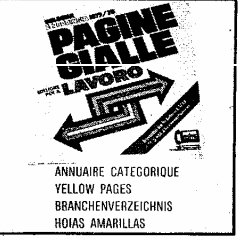
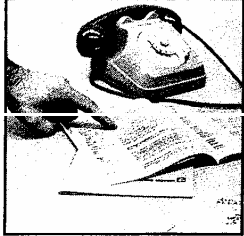
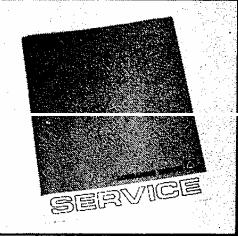

**ORDINI RICAMBI
COMMANDES PIECES
PART ORDERS
E-TEIL BESTELLUNG
PEDIDOS DE REPUESTO**

**TIPO MOTORE
TYPE DE MOTEUR
ENGINE TYPE
MOTORTYP
TIPO DEL MOTOR**

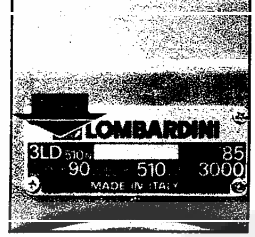
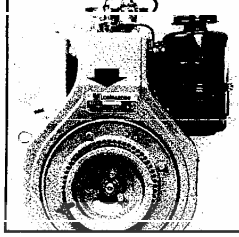

**MATRICOLA
MATICULE
SERIAL NUMBER
MOTORENNUMMER
NUMERO DEL MOTOR**

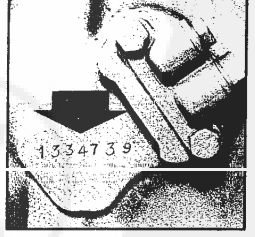
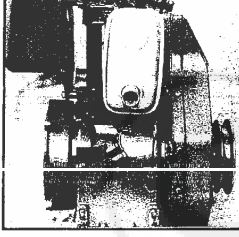
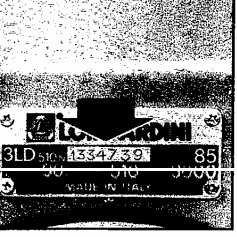
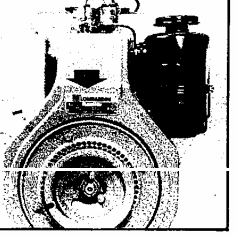

**TIPO DELLA MACCHINA
TYPE DE MACHINE
EQUIPMENT TYPE
MASCHINENTYP
MODELO DE LA MAQUINA**

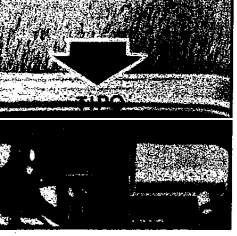
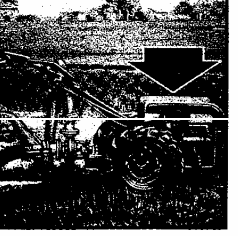

**MATRICOLA del ricambio
REFERENCE de la pièce
SPARE PART number
BESTELNUMMER des Teiles
REFERENCIA dei repuesto**

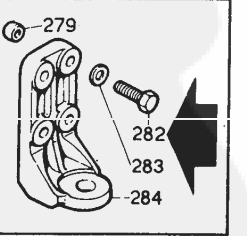
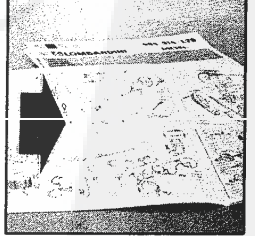

LOMBARDINI ENGINE
LOMBARDINI FRANCE
LOMBARDINI MOTORI
LOMBARDINI MOTORS

RICAMBI PER MOTORE STANDARD.
PER APPLICAZIONI SPECIALI CONSULTARE
IL CATALOGO PRESSO I CENTRI ASSISTENZA
E RICAMBI.

PIECES POUR DES MOTEURS STANDARD.
POUR LES ADAPTATIONS CONSULTER
LE CATALOGUE AUPRES
DES AGENTS SERVICE.

SPARE PARTS FOR STAN
FOR SPECIAL APPLICATI
CATALOG AT SERVICE CE

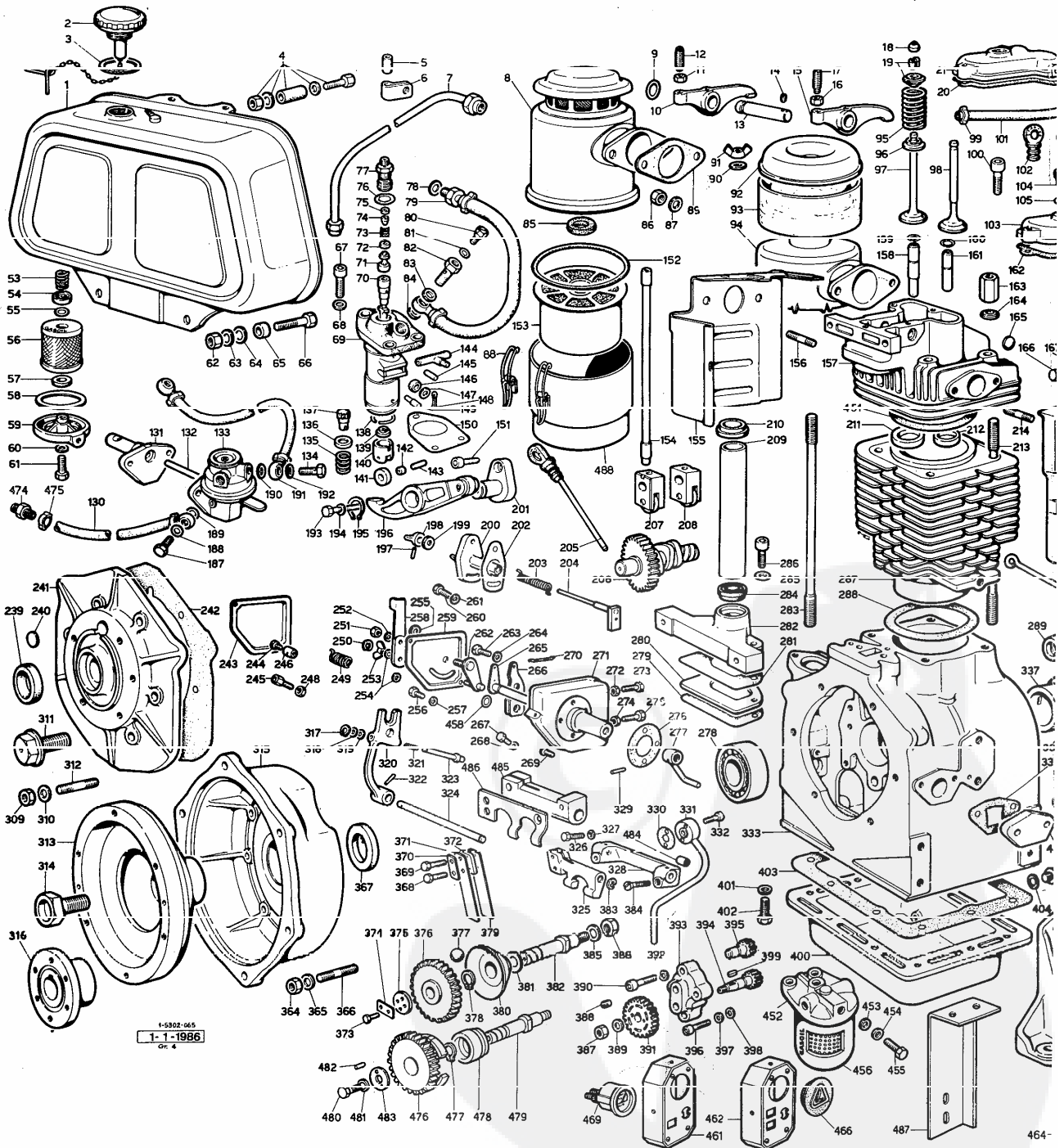

STANDARD ENGINE.
APPLICATIONS SEE MASTER
LISTING CENTERS.

ERSATZTEILE FÜR STANDARD-MOTOREN.
FÜR SONDERANFERTIGUNGEN SIEHE
ERSATZTEILKATALOG BEI SERVICE
WERKSTÄTTEN.

REPUESTOS PARA MOTORES STANDARD.
PARA APLICACIONES VEASE CATALOGO
EN LAS ESTACIONES SERVICE.

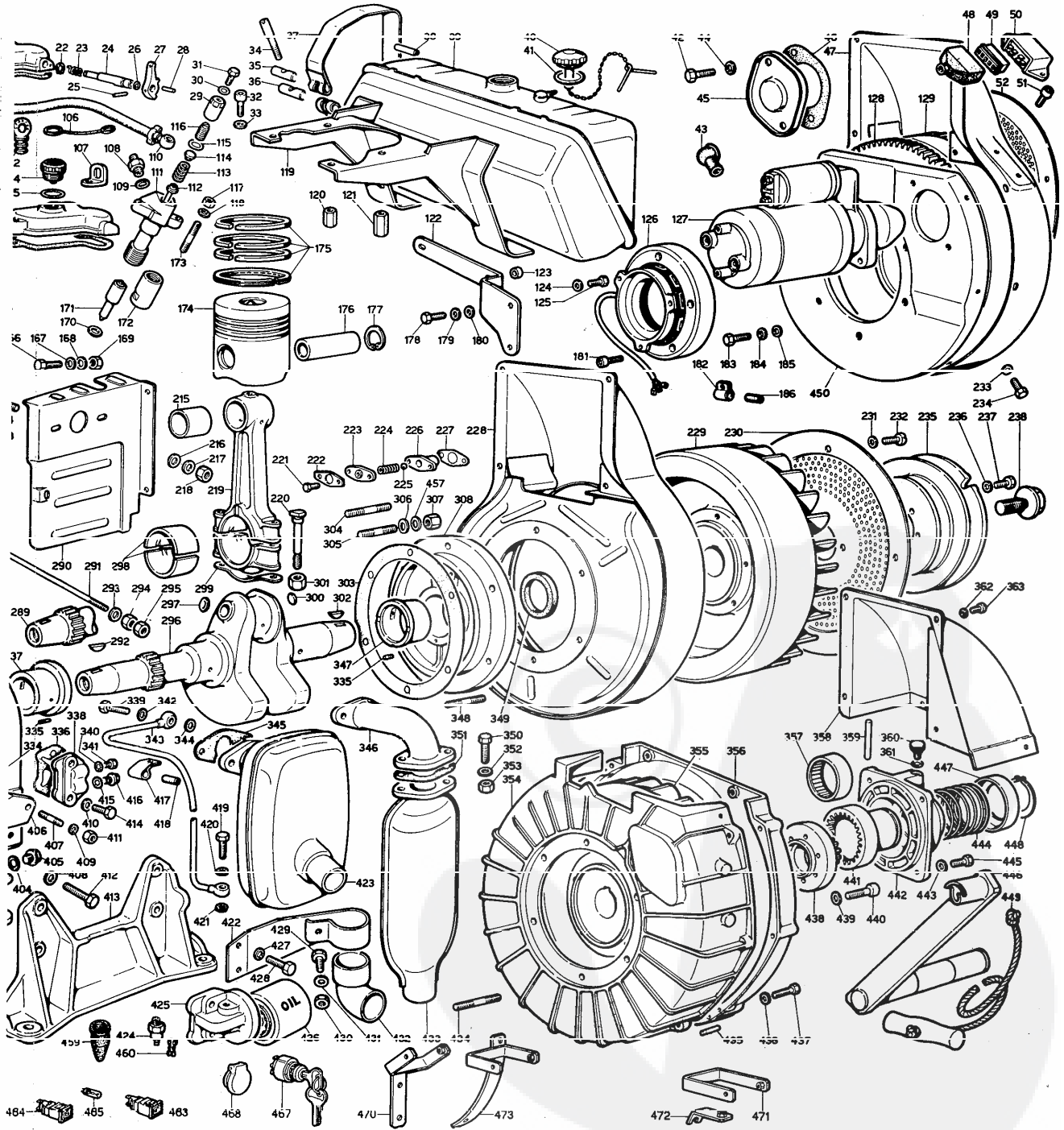

9345-33
Tubo 2

6184-6727-03
Pre-filtro

271-3334-34
Decalcomania

8060-3700-96
Filtro aria

270-4115-29
Gancio 2

5330-05
Spessore

8740-17
Supporto

261-3615-26
Fascetta

260-3690-24
Fascetta 4

263-9425-05
Tubo

30-7555-08
Rondella 2

236-3240-37
Dado (6x1,5) 2

3750-41
Plangia

270-4500-05
Guarnizione 2

890-2200-50
Prigionero (6x1,5) 2

261-3615-20
FASCETTA CONPL.

260-9730-36
Vite (6x1,25)

254-1557-07
Bioschermo

254-1557-18
Bioschermo

NOTE - REMARQUES - REMARKS
-In ambiente polveroso.
-Dans une atmosphère poussiéreuse.
-Under dusty conditions,
-Fornito separato.
-Livré séparé
-Separately supplied.

* NON FORNITO SECONDO
NON LIVRE SEPARATEMENT
NOT SUPPLIED SEPARATELY

| | | |
|--|---|--|
| COMPLESSIVO - GROUPE - ASSEMBLY | FILTRO ARIA PREDIS. PREFILTRO A CICLONE FILTRE A AIR ADAPT. POUR PREFILTRE CYCL. AIR CLEANER SUITABLE FOR CYCL. PREFILTER | TAVOLA TABLE 4 41 14 |
| MOTORE O VERSIONE MOTEUR OU ADAPTATION ENGINE OR VERSION | LDA 96-97-100 (K.9954.32) | FOGLIO FEUILLE PAGE DATE 2-73 |

370.167

6184-9345-79
Tubo

270-4500-50
Prigionero (6x1,5) 2

5630-24
Fascetta 2

270-4500-05
Guarnizione 2

6184-9345-41
Filtro aria

271-3334-34
Decalcomania

270-4115-29
Gancio 3

270-3525-80
Spessore

270-5496-08
Massa filtrante

1002-9731-22
Vite (2x1,5) 1

205-7625-26
Rondella 3

6184-6727-03
Pre-filtro

8104-8301-71
Supporto

8021-3206-20
Dado 2

8021-3206-19
Dado 2

30-7555-08
Rondella 2

236-3240-37
Dado (6x1,5) 2

270-4450-16
Guarnizione

NOTE - REMARQUES - REMARKS
-In ambiente polveroso.
-Dans une atmosphère poussiéreuse.
-Under dusty conditions,
-Con presa aria laterale.
-Avec prise d'air latérale.
-With side air inlet.

* NON FORNITO SECONDO
NON LIVRE SEPARATEMENT
NOT SUPPLIED SEPARATELY

| | | |
|--|--|--|
| COMPLESSIVO - GROUPE - ASSEMBLY | FILTRO ARIA FILTRE A AIR AIR CLEANER | TAVOLA TABLE 4 41 15 |
| MOTORE O VERSIONE MOTEUR OU ADAPTATION ENGINE OR VERSION | LDA 96-97-100 (K.9954.45) | FOGLIO FEUILLE PAGE DATE 2-73 |

| Tipo motore Engine type | Blocco motore Short block |
|----------------------------|------------------------------|
| 4LD640 industr. | 2720.1560.033 |
| " automot. | 2720.1560.034 |
| 4LD705 automot. | 2790.1560.015 |
| " industr. | 2790.1560.016 |
| 4LD820 industr. | 2910.1560.049 |
| " automot. | 2910.1560.050 |

| FIG. NO. | MATRICOLA P.NO | Q.TA Q.TY | NOTE REMARKS | GR. 4 PAG.02 |
|--------------------------------------|-----------------------|-----------|---|-----------------|
| 1+2+3= | | | SERBATOIO COMPLETO LATO DISTRIB. GEAR SIDE FUEL TANK | |
| | =270.8101.018 F C | 1 | std. capacity 1.7 | |
| | =2790.8103.008 S IC | 1 | piatto /flat capacity 1.7,5 | |
| 2+3= | | | TAPPO/CAP | |
| | =285.9043.037 FV C | 1 | x serbatoio/f.tank 1.7 | |
| | =2830.9043.025 FV C | 1 | x serbatoio/f.tank 1.7,5 | |
| 3+ | 9.1200.015 FV C 10 | 1 | x serbatoio/f.tank 1.7 | |
| " | 2700.4650.056 DV C 10 | 1 | x serbatoio/f.tank 1.7,5 | |
| 4 | 2830.9135.012 F C 10 | 2 | tassello/cushion | |
| 5 | 260.5390.006 S C 10 | 1 | manicotto/rubber sheating | |
| 6 | 2830.3617.016 S C 10 | 1 | fascetta/strip fixing | |
| 7 | 270.9370.009 FV C | 1 | tubo comb./fuel pipe | |
| 8+85+88+152+153+ 488+489= | | | FILTRO ARIA CON CAPPELLOTTO AIR CLEANER WITH INLET COVER | |
| | =272.3700.139 FVIC | 1 | x 4LD640-640/L-705-820/L | |
| | =291.3702.016 E | 1 | x 4LD820 | |
| | =291.3700.141 FV C | 1 | x 4LD820 | |
| 9+ | 9.1200.027 FV C 10 | 1 | anello OR/rubber oil seal | |
| 10+9+11+12+13+14+15+ 16+17= | | | GRUPPO BILANCIERI COMPLETO ROCKER ARM ASS.Y | |
| | =291.4330.023 F C | 1 | x 4LD640-705-820 | |
| | =291.4330.038 D C | 1 | x 4LD640/L-820/L | |
| 11+ | 9.3240.010 FV C 10 | 1 | dado/nut | |
| 12+ | 270.9850.002 F C 10 | 1 | vite/screw | |
| 13: | 271.6045.029 FV C 10 | 1 | perno bil./rocker shaft 4LD640-705-820 | |
| " | 291.6045.034 S C | 1 | " " 4LD640/L-820/L | |
| 14+ | 9.9765.051 F C 10 | 1 | vite/screw M 6 X 1 X 8 | |
| 15+ | | | vedi/see fig.No. 10+... | |
| 16+ | 9.3240.010 FV C 10 | 1 | dado/nut | |
| 17+ | 270.9850.002 F C 10 | 1 | vite/screw | |
| 18+ | 270.2135.067 FV C 10 | 1 | cappellotto/cap | |
| 19+ | 260.6410.010 F C 10 | 2 | piattello/retainer wiht half-colletts | |
| 20 | 270.4400.008 FV C 50 | 1 | guarnizione/joint 0,30 | |
| 21+22+23+24+25+26+27+ 28+100+107= | | | CAPPELLO BILANC.CON DECOMPRESSIONE ROCKER BOX CAP WITH DECOMPRESSION | |
| | =272.2125.087 F IC | 1 | | |
| 22+ | 9.1165.004 FV C 10 | 1 | anello/circlip | |
| 23+ | 270.5680.024 FV C 10 | 1 | molla/spring | |
| 24+ | 270.1110.038 F | 1 | albero/decompression shaft | |
| 25+ | 9.8430.023 S C 10 | 1 | spina/taper pin | |
| 26+ | 9.1200.034 FV C 10 | 1 | anello OR/rubber oil seal | |
| 27+ | 500.5270.078 F C | 1 | leva/lever | |
| 28+ | 9.8430.023 S C 10 | 1 | spina/taper pin | |

| FIG. NO. | MATRICOLA P.NO | Q.TA Q.TY | NOTE REMARKS | GR. 4 PAG.03 |
|-----------------------|----------------|---------------|--|---|
| 29+ | 260.4130.053 | SV C | 1 ghiera/ring nut | |
| 30 | 9.4470.058 | FV C 10 | 2 guarnizione/copper joint | |
| 31+ | 9.1901.029 | FVIC 10 | 1 bullone raccordo/connection bolt | |
| 32 | 9.9731.023 | F C 10 | 4 vite/screw M 12 X 1,5 X 16 | |
| 33 | 9.7565.013 | S C 10 | 4 rondella/washer | |
| 34+ | 45.1860.065 | F C 10 | 2 bullone/bolt | |
| 35+ | 45.1557.019 | F C 10 | 2 blocchetto/nut | |
| 36+ | 45.1557.020 | F C 10 | 2 blocchetto/nut | |
| 37+34+35+36= | =271.3616.009 | F C 10 | 2 FASCETTA FISSAGGIO SERBATOIO fuel tank fixing clamp | |
| 38 | 271.9600.057 | FV C 10 | 2 tubetto/rubber sheathing | |
| 39+40+41= | =273.8101.021 | F C | 1 SERBATOIO COMPLETO LATO VOLANO FLYWHELL SIDE FUEL TANK | |
| 40+41= | =285.9043.037 | FV C | 1 TAPPO SERBATOIO FUEL TANK CAP | |
| 41+ | 9.1200.015 | FV C 10 | 1 anello OR/rubber oil seal | |
| 42 | 9.6820.014 | D 10 | 2 prigioniero/stud M 12 X 30 (48) | |
| 43 | 2830.6491.005 | FV C | 1 pipetta/pipe elbow | |
| 44 | 9.7625.026 | S 10 | 2 rondella/washer | |
| 45 | 270.6685.045 | S | 1 portina/cover | |
| 46 | 422.4773.042 | N 50 | 1 guarnizione/joint | |
| 47 | 270.2565.070 | F C | 1 convogliatore/shroud | |
| 48 | 276.2145.014 | FVAC 10 | 1 cappuccio/rubber cap | |
| 49 | 276.6740.088 | FVAC 10 | 1 presa/inlet regolat./regul.Saprisa | |
| " | 276.6740.089 | SVAC 10 | 1 presa/inlet regolat./regul.Ducati | |
| " | 276.6740.090 | SVAC 10 | 1 x reg.Ducati con spia car.batteria with ch.battery light | |
| 50 | 2760.7362.027 | FVIC | 1 regol.tens./voltage regul. 12 V 12 A | |
| " | 9040.7362.066 | FVIC | 1 12 V 12 A con spia carica batteria with charg.battery light | |
| 51 | 9.9731.092 | S 10 | 2 vite/screw M 8 X 1,25 X 14 | |
| 52 | 291.5095.081 | S C | 1 lamiera/panel 4LD820 | |
| 53+ | 273.5575.006 | FV C 10 | 1 molla/spring | |
| 54+ | 273.3930.019 | F C 10 | 1 fondello/cup | |
| 55+ | 9.1200.032 | FV C 10 | 1 anello OR/rubber oil seal | |
| 56+53+54+55+57+58+59+ | 60+61= | =273.3730.015 | FV C | 1 FILTRO COMBUSTIBILE COMPLETO FUEL FILTER |
| 56+ | 273.2175.009 | FV C | 1 cartuccia comb./f.filter element | |
| 57+ | 273.4490.017 | FV C 10 | 1 guarnizione/joint | |
| 58+ | 260.4430.071 | FV C 10 | 1 guarnizione/joint | |
| 59+ | 273.2605.033 | F AC | 1 coperchio/filter cover | |
| 60+ | 9.1202.052 | FVAC 10 | 1 anello OR/rubber oil seal | |
| 61+ | 9.1760.076 | D A | 1 bullone/bolt | |
| 62 | 9.3240.018 | FV 10 | 2 dado/nut | |
| 63 | 9.7565.007 | F C 10 | 2 rondella/washer | |
| 64 | 9.7625.012 | FV C 10 | 2 rondella/washer | |
| 65 | 270.3525.093 | S C 10 | 2 x serb./f.tank capacity 1.7.5 | |
| 66 | 9.1770.011 | S C 10 | 2 bullone/bolt std. M 8 X 1,25 X 40 | |
| " | 9.1770.031 | N 10 | 2 x avv.eletttr/elec.st.-M 8X1,25X50 | |
| 67 | 9.9730.100 | F 10 | 3 vite/screw M 8 X 1,25 X 25 | |
| 68 | 9.7625.010 | FV C 10 | 3 rondella/washer | |

| FIG. NO. | MATRICOLA P.NO | Q.TA Q.TY | NOTE REMARKS | GR. 4 PAG.04 |
|----------|---|-----------|--|--------------|
| | 69+70+71+72+73+74+75+ 76+77+135+136+137+138+ 139+140+141+142+143+ 144+145+149= | | POMPA INIEZIONE COMPLETA INJECTION PUMP | |
| | =283.6590.033 F C | 1 | std. | |
| | =283.6590.041 F C | 1 | Bosch type | |
| 70+ | 283.6578.013 FV C | 1 | pompante/injection plunger std. | |
| " | 283.6578.020 FV C | 1 | " " " " Bosch | |
| 71+ | 273.9672.013 F C | 1 | valvolina mandata/delivery valve std. | |
| " | 273.9672.016 F C | 1 | " " " " Bosch | |
| 72+ | 271.4760.015 FV C 10 | 1 | guarnizione/joint | |
| 73+ | 271.5755.034 SV C 10 | 1 | molla/spring | |
| 74+ | 271.7470.003 FV C 10 | 1 | riempitore/filler | |
| 75+ | 271.8335.029 SV C 10 | 1 | spessore/shim | |
| 76+ | 9.1200.031 FV C 10 | 1 | anello OR/rubber oil seal | |
| 77+ | 271.7265.008 FV C 10 | 1 | raccordo/connection | |
| 78 | 9.4670.058 FV C 10 | 1 | guarnizione/copper joint | |
| 79 | 2830.9371.071 E | 1 | tubo da serb.lato.dist.a pompa in. mm 273 pipe from gear side f.tank to inj.pump x serb./f.tank capacity L.7 | |
| " | 273.9375.274 FVAC | 1 | " " " " mm 253 | |
| " | 7150.9375.116 E | 1 | x serb./f.tank capacity L.7,5 mm 370 | |
| " | 2830.9375.290 FVAC | 1 | " " " " mm 355 | |
| " | 2790.9371.086 F | 1 | tubo da serb.lato vol.a pompa in. mm 500 pipe for flywh.side f.tank to inj.pump | |
| " | 2790.9375.289 D AC | 1 | " " " " mm 495 | |
| 80 | 9.9080.037 FV C 10 | 1 | tappo/deaeration cap. | |
| 81 | 9.4775.196 SV C 10 | 1 | guarnizione/joint | |
| 82 | 9.1901.031 FVIC 10 | 1 | bullone raccordo/connection bolt | |
| 83 | 9.4670.060 FV C 10 | 1 | guarnizione/copper joint | |
| 84 | 9.4670.060 FV C 10 | 1 | guarnizione/copper joint | |
| 85+ | 270.3525.000 F IC 10 | 1 | distanziatore/spacer diam.= 61 | |
| " | 292.1261.073 DVAC 10 | 1 | " " " " diam.= 62,5 | |
| 86 | 9.3240.037 F | 10 | dado/nut | |
| 87 | 9.7555.008 FV C 10 | 2 | rondella/washer | |
| 88+ | 276.4115.048 F C 10 | 2 | gancio/hook | |
| 89+ | 710.4501.003 FV C 50 | 2 | guarnizione/joint | |
| 90+ | 9.7555.004 FV C 10 | 1 | rondella/washer | |
| 91+ | 9.3200.002 FV C 10 | 1 | dado/nut | |
| 92+ | 271.2125.056 F C | 1 | cappello/inlet air cap | |
| 93+ | 2910.1301.069 FV C 10 | 1 | prefiltro/cyclonic prefilter | |
| | 94+85+88+90+91+92+ 93+94+152+153+488= | | FILTRO ARIA CON PREFILTRO CYCLONIC TYPE AIR CLEANER | |
| | =272.3702.019 E | 1 | x 4LD640-640/L-705-820/L | |
| | =272.3700.140 SV C | 1 | x 4LD640-640/L-705-820/L | |
| | =291.3702.017 E | 1 | x 4LD820 | |
| | =291.3700.142 DV C | 1 | x 4LD820 | |
| 95+ | 260.5755.004 FV C | 2 | molla/spring | |
| 96+ | 291.6410.037 F IC 10 | 2 | piattello/retainer | |
| 97+ | 291.9652.019 FV CR10 | 1 | valvola aspirazione/inlet valve | |
| 98+ | 291.9685.031 FV CR10 | 1 | valvola scarico/exhaust valve | |
| 99+ | | | | |
| 100+ | 9.9732.063 S AC 10 | 2 | vite/screw M 8 X 1,25 X 35 | |
| 101 | 270.9570.067 FV C 10 | 1 | tubo spurgo in./bleeding pipe x serb.l.distr./gear side f.tank | |
| " | 2790.9570.044 D C | 1 | x serb.l.volano/flywh.side f.tank | |
| 102 | 270.9055.003 FV C 10 | 1 | tappo/starter cap | |

| FIG. NO. | MATRICOLA P.NO | Q.TA Q.TY | NOTE REMARKS | GR. 4 PAG.05 |
|------------------------|--------------------|-----------|---|--------------|
| 103+100+107= | =272.2125.003 S IC | 1 | CAPPELLO BILANCIERI std. ROCKER BOX CAP | |
| 104+105= | =270.9050.021 FV C | 1 | TAPPO SFIATO/BREATHER CAP std. | |
| 105+ | 9.1200.014 FVIC | 10 | 1 anello OR/rubber oil seal | |
| 106 | 500.3695.038 F C | 10 | 1 filo/wire | |
| 107+ | 904.8506.003 S AC | 10 | 1 squadretta/angle bracket | |
| 108 | 260.7300.033 E | 1 | 1 raccordo/connection | |
| | 500.7301.006 D I | 1 | | |
| 109 | 260.4650.037 DV C | 10 | 1 guarnizione/joint | |
| 110+ | 9.7270.020 SV C | 10 | 1 raccordo/connection | |
| 111+29+31+112+113+114+ | | | PORTAPOLVERIZZATORE COMPLETO | |
| 115+116+171+172= | =291.6615.015 F C | 1 | NOZZLE HOLDER std. | |
| | =291.6615.028 D C | 1 | Bosch type | |
| 111+29+31+112+113+114+ | | | CORPO POLVERIZZATORE | |
| 115+116+172= | =260.6615.001 D | 1 | NOZZLE HOLDER BODY | |
| 112+ | 260.1420.012 DV C | 1 | 1 asta comando/control rod | |
| 113+ | 260.5800.038 SV C | 1 | 1 molla/spring | |
| 114+ | 260.8010.002 DV C | 1 | 1 sede/seat | |
| 115+ | 260.4370.007 DV C | 10 | 1 guarnizione/joint | |
| 116+ | 260.1570.016 DV C | 1 | 1 bocchettone/filler cap | |
| 117 | 9.3240.018 FV | 10 | 2 dado/nut | |
| 118 | 9.7565.007 F C | 10 | 2 rondella/washer | |
| 119 | 2790.8865.053 D C | 1 | 1 supporto/support | |
| 120 | 2790.3206.020 DV C | 10 | 2 dado/nut | |
| 121 | 2790.3206.019 DV C | 10 | 2 dado/nut | |
| 122 | 2720.8545.085 S A | 1 | 1 staffa/brace | |
| 123 | 272.3526.079 D | 10 | 2 distanziale/spacer | |
| 124 | 9.7565.004 F C | 10 | 3 rondella/washer | |
| 125 | 9.1760.005 FV | 10 | 3 bullone/bolt M 6 X 1 X 16 | |
| 126 | 283.1156.090 FVIC | 1 | 1 alternatore/voltage altern.12V 12A | |
| 127 | 272.5840.066 F I | 1 | 1 mot.avv./start.eng.12 V Bosch type | |
| 128 | 270.2816.011 F C | 1 | 1 corona avviamento/crown gear | |
| 129 | 270.9881.006 S C | 1 | 1 volano avv.elett./el.starting flywheel | |
| 130 | 5000.9375.240 S AC | 1 | 1 tubo da serbatoio a pompa aliment. mm 377 pipe from fuel tank to feed pump | |
| 131 | 271.8901.080 S IC | 1 | 1 supporto/support | |
| 132 | 270.6495.012 D C | 1 | 1 pistoncino/plunger | |
| 133 | 283.6585.031 FV C | 1 | 1 pompa alimentazione/feed pump | |
| 134 | 9.1901.030 FVIC | 10 | 1 bullone raccordo/connection bolt | |
| 135+ | 260.5625.002 SV C | 1 | 1 molla/spring | |
| 136+ | 260.7980.020 SV C | 1 | 1 scodellino/cup | |
| 137+ | 260.4850.009 FV C | 1 | 1 guida/guide | |
| 138+ | 9.1260.084 DV C | 10 | 1 anello/ring | |
| 139+ | 260.6400.024 D | 1 | 1 piattello/retainer | |
| 140+ | 260.7215.017 FV C | 1 | 1 punteria/tappet | |
| 141+ | 260.7770.020 SV C | 1 | 1 rullo/roller | |
| 142+ | 260.1970.054 DV C | 1 | 1 bussola/sleeve | |
| 143+ | 260.6230.068 SV C | 1 | 1 perno/pin | |
| 144+ | 270.1415.007 DV C | 1 | 1 asta comando/control rod | |
| 145+ | 277.6230.075 S | 10 | 1 perno/pin | |
| 146 | 270.1580.016 F C | 10 | 1 boccia/bushing | |
| 147 | 9.7626.017 D C | 10 | 1 rondella/washer | |
| 148 | 9.2800.003 F C | 10 | 1 copiglia/cotter pin | |

| FIG. NO. | MATRICOLA P.ND | Q.TA Q.TY | NOTE REMARKS | GR. 4 PAG.06 |
|------------------------|----------------------|-----------|--------------------------------------|--------------|
| 149+ | 260.6230.069 DV C | 1 | perno/pin | |
| 150+ | 283.4580.001 D | 50 | 1 guarnizione/joint 0,10 | |
| " | 283.4580.008 N | 50 | 1 " " 0,50 | |
| " | 283.4580.012 N | 50 | 1 " " 0,30 | |
| " | 283.4580.039 N | 10 | 1 " " 0,05 | |
| 151 | 9.9732.092 F C | 10 | 1 vite/screw M 8 X 1,25 X 18 | |
| 152+ | 291.4776.032 FV C | 10 | 1 guarnizione/joint | |
| 153+ | 292.5496.111 FVIC | 1 | 1 x 4LD640-640/L-705-820/L | |
| " | 291.5496.051 E | 1 | 1 x 4LD820 | |
| " | 291.5496.118 FVIC | 1 | 1 " | |
| 154 | 270.1410.011 FV C | 2 | 2 asta punteria/push rod | |
| 155 | 270.5065.009 F C | 1 | 1 lamiera/airtight plate | |
| 156+ | 9.6800.050 S I | 10 | 2 prigioniero/stud M 10 X 23 (38) | |
| 157+9+10+11+12+13+14+ | | | TESTA COMPLETA | |
| 15+16+17+18+19+95+96+ | | | CYLINDER HEAD | |
| 97+98+156+158+159+160+ | | | | |
| 161+165+173+211+212+ | | | | |
| 214= | =291.9201.003 F C | 1 | | |
| 157+156+158+159+160+ | | | TESTA CON SEDI E GUIDE | |
| 161+173+211+212+214= | =291.9201.004 F C | 1 | CYLINDER HEAD WITH SEATS AND GUIDES | |
| 158+ | 291.4845.054 FV CR10 | 1 | 1 guida v.aspir./inlet v.guide std. | |
| " | 291.4845.060 FV CR10 | 1 | 1 " " +0,50 | |
| 159+ | 291.1160.013 FV C 10 | 1 | 1 anello/circlip | |
| 160+ | 291.1160.013 FV C 10 | 1 | 1 anello/circlip | |
| 161+ | 291.4845.055 FV CR10 | 1 | 1 guida v.scar./exhaust v.guide std. | |
| " | 291.4845.061 FV CR10 | 1 | 1 " " +0,50 | |
| 162+ | 270.4400.007 FV C 50 | 1 | 1 guarnizione/joint 0,50 | |
| 163 | 270.3206.015 FV C 10 | 1 | 1 dado/nut | |
| 164 | 9.7625.055 SV C 10 | 4 | 4 rondella/washer | |
| 165+ | 9.8990.017 F C 10 | 1 | 1 tappo/plug | |
| 166 | 9.1760.003 F 10 | 4 | 4 bullone/bolt M 6 X 1 X 12 | |
| 167 | 9.7565.004 F C 10 | 4 | 4 rondella/washer | |
| 168 | 9.7625.007 S C 10 | 3 | 3 rondella/washer | |
| 169 | 9.3240.008 FV 10 | 3 | 3 dado/nut | |
| 170 | 9.4670.009 FV C 10 | 1 | 1 guarnizione/copper joint 0,50 | |
| " | 9.4670.010 FV C 10 | 1 | 1 " " 1,00 | |
| " | 9.4670.011 FV C 10 | 1 | 1 " " 1,50 | |
| 171+ | 710.6531.033 FVIC | 1 | 1 polverizzatore/nozzle | |
| 172+ | 260.4130.052 SV C | 1 | 1 ghiera/ring nut | |
| 173+ | 9.6780.018 FV C 10 | 2 | 2 prigioniero/stud M 8 X 28 (43) | |
| 174+175+176+177= | | | PISTONE COMPLETO/PISTON SET | |
| =272.6500.070 FV C | 1 | 1 | 1 std. x 4LD640-640/L | |
| =272.6500.071 F CR | 1 | 1 | 1 +0,50 | |
| =272.6500.072 F CR | 1 | 1 | 1 +1,00 | |
| =279.6501.021 FV C | 1 | 1 | 1 std. x 4LD705 | |
| =279.6501.022 F CR | 1 | 1 | 1 +0,50 | |
| =279.6501.023 F CR | 1 | 1 | 1 +1,00 | |
| =291.6501.070 FV C | 1 | 1 | 1 std. x 4LD820-820/L | |
| =291.6501.071 F CR | 1 | 1 | 1 +0,50 | |
| =291.6501.072 F CR | 1 | 1 | 1 +1,00 | |

| FIG. NO. | MATRICOLA P.NO | Q.TA Q.TY | NOTE REMARKS | GR. 4 PAG.07 |
|----------------------|----------------|-----------|--|--------------|
| 175+ | 276.8210.052 | FV C 10 | 1 serie segm./ring set std. 4LD640-640/L | |
| " | 276.8210.053 | F CR10 | 1 " " +0,50 | |
| " | 276.8210.054 | F CR10 | 1 " " +1,00 | |
| " | 279.8210.049 | FV C 10 | 1 " " std. 4LD705 | |
| " | 279.8210.050 | F CR10 | 1 " " +0,50 | |
| " | 279.8210.051 | F CR10 | 1 " " +1,00 | |
| " | 291.8210.058 | FV C 10 | 1 " " std. 4LD820-820/L | |
| " | 291.8210.059 | F CR10 | 1 " " +0,50 | |
| " | 291.8210.060 | F CR10 | 1 " " +1,00 | |
| 176+ | 272.8480.010 | F C | 1 spinotto/gudgeon pin 4LD640-640/L | |
| " | 279.8480.021 | S C | 1 " " 4LD705 | |
| " | 291.8480.025 | D C | 1 " " 4LD820-820/L | |
| 177+ | 9.1240.026 | FV C 10 | 2 anello seeger/snap ring | |
| 178 | 9.1760.048 | D 10 | 2 bullone/bolt | |
| 179 | 9.7565.004 | F C 10 | 2 rondella/washer | |
| 180 | 9.7625.070 | D C 10 | 2 rondella/washer | |
| 181 | 9.9730.015 | F C 10 | 5 vite/screw M 6 X 1 X 30 | |
| 182 | 2790.3617.017 | D 10 | 1 fascetta/strip fixing | |
| 183 | 9.1790.025 | F C 10 | 1 bullone/bolt M 12 X 1,25 X 30 | |
| 184 | 9.7565.013 | S C 10 | 1 rondella/washer | |
| 185 | 9.7625.026 | S 10 | 1 rondella/washer | |
| 186 | 260.5390.006 | D 10 | 1 manicotto/rubber sheathing | |
| 187 | 9.1901.030 | FVIC 10 | 1 bullone raccordo/connection bolt | |
| 188 | 9.4670.059 | FVIC 10 | 1 guarnizione/copper joint | |
| 189 | 9.4670.059 | FVIC 10 | 1 guarnizione/copper joint | |
| 190 | 9.4670.059 | FVIC 10 | 1 guarnizione/copper joint | |
| 191 | 2790.9372.001 | DV C | 1 tubo da pompa alim. a pompa iniezione pipe from feed pump to injection pump | |
| 192 | 9.4670.059 | FVIC 10 | 1 guarnizione/copper joint | |
| 193 | 9.1770.015 | F 10 | 1 bullone/bolt M 8 X 1,25 X 55 | |
| 194 | 9.7565.007 | F C 10 | 1 rondella/washer | |
| 195 | 9.1240.013 | D 10 | 1 anello seeger/snap ring | |
| 196 | 270.4330.028 | F IC | 1 bilanc.pompa iniez./inj.pump rocker | |
| 197+ | 9.8420.001 | D C 10 | 1 spina/locating pin | |
| 198+ | | | vedi/see fig.No. 200+... | |
| 199+ | 9.1200.041 | FV 10 | 1 anello OR/rubber oil seal | |
| 200+197+198+199+203+ | | | COMANDO SUPPLEMENTO | |
| 204= | | | DEVICE CONTROL | |
| | =272.2516.045 | F IC | 1 | |
| 201 | 271.6045.009 | F U | 1 perno/pin | |
| 202+ | 270.4700.070 | N 50 | 1-3 guarnizione/joint 0,50 | |
| 203+ | 270.5550.007 | SV C 10 | 1 molla/spring | |
| 204+ | | | vedi/see fig.No. 200+... | |
| 205 | 270.1400.005 | F C 10 | 1 asta liv./dipstick std. 4LD640-640/L-705 | |
| " | 291.1400.045 | F C 10 | 1 " " std. 4LD820-820/L | |
| 206 | 291.1010.060 | F C | 1 albero a camme/camshaft | |
| 207 | 270.4887.002 | FV C | 1 punteria/tappet | |
| 208 | 270.4887.001 | FV C | 1 punteria/tappet | |
| 209 | 270.9520.023 | S C | 1 tubo prot./guard tube | |
| 210 | 292.4740.017 | FV C 10 | 1 guarnizione/joint | |
| 211+ | 291.8000.046 | FV CR10 | 1 sede v.aspirazione/inlet v.seat | |
| 212+ | 291.8000.047 | FV CR10 | 1 sede v.scarico/exhaust v.seat | |
| 213+ | 270.6850.040 | S C | 2 prigioniero/stud | |
| 214+ | 9.6800.050 | S I 10 | 2 prigioniero/stud M 10 X 23 (38) | |
| 215+ | 270.1630.006 | FV CR10 | 1 bronz.piede biella/small end bearing | |
| 216 | 9.7625.019 | S 10 | 2 rondella/washer | |
| 217 | 9.7565.011 | F C 10 | 2 rondella/washer | |
| 218 | 9.3240.053 | FV C 10 | 2 dado/nut | |

| FIG. NO. | MATRICOLA P.NO | Q.TA Q.TY | NOTE REMARKS | GR. 4 PAG.08 |
|--|--------------------|-----------|--|-----------------|
| 219+215+220+301= =270.1526.002 F C | | | 1 BIELLA COMPLETA CONNECTING ROD ASS.Y | |
| 220+ | 270.1860.007 FV C | 10 | 2 bullone/bolt | |
| 221+ | 9.1760.003 F | 10 | 2 bullone/bolt M 6 X 1 X 12 | |
| 222+ | 271.5110.084 D C | 10 | 1 lamierino/tabwasher | |
| 223+ | 271.3895.005 D C | | 1 flangia/flange | |
| 224+ | | | vedi/see fig.No. 226+... | |
| 225+ | 9.8245.005 D C | 10 | 1 sfera/ball | |
| 226+221+222+223+224+ 225+227= =273.9680.010 FV C | | | 1 VALVOLINA DI PRESSIONE COMPLETA PRESSURE OIL VALVE ASS.Y | |
| 227+ | 271.4760.007 DV C | 10 | 1 guarnizione/joint | |
| 228 | 270.2565.076 F IC | | 1 convogliatore/shroud | |
| 229 | 270.9881.006 S C | | 1 volano/flywheel std. | |
| 230 | 270.5095.057 F C | | 1 lamiera/panel guard 4LD640-640/L-705 | |
| 231 | 9.7540.006 D C | 10 | 4 rondella/washer std. | |
| " | 9.7540.004 D C | 10 | 4 x avv.elettrico/electric starting | |
| 232 | 9.9810.012 S | 10 | 4 vite/screw std. | |
| " | 9.9810.007 S C | 10 | 4 x avv.elettrico/electric starting | |
| 233 | 271.7500.018 SV C | 10 | 7 rondella/washer | |
| 234 | 9.1755.001 FV | 10 | 7 bullone/bolt M 5 X 0,8 X 8 | |
| 235 | 270.4960.041 FV C | | 1 puleggia avv./st.pulley std. | |
| " | 2790.6960.054 FV C | | 1 x pompa oleodinam./hydraulic pump | |
| " | 2790.6960.078 S | | 1 puleggia 2 gole/2 grooves pulley | |
| 236 | 9.7555.007 DV C | 10 | 6 rondella/washer | |
| 237 | 9.1770.006 S | 10 | 6 x puleggia/pulley std. MBX1,25X25 | |
| " | 9.1770.015 F | 10 | 6 x puleggia per pompa oleodinamica pulley for hydr.pump MBX1,25X55 | |
| " | 9.1770.017 S | 10 | 6 x pul. 2 gole/grooves MBX1,25X60 | |
| 238 | 270.1860.011 S C | | 1 bullone/bolt | |
| 239 | 9.1210.031 FV C | 10 | 1 anello tenuta/seal ring | |
| 240+ | 9.8990.008 S | 10 | 1 tappo/plug | |
| 241+240= =272.6646.091 D IC | | | 1 PORTINA LATO DISTRIBUZIONE GEAR SIDE CASE COVER | |
| 242+ | 270.4431.004 SV C | 50 | 1 guarnizione/joint 0,30 | |
| " | 270.4431.010 N | 50 | 1 " " " 0,10 | |
| 243+244+245+246+248+ 249+256+257+263+264+ 265+266+270+271+272+ 273+274+275+277+329+ 458= =273.2515.027 F IC | | | 1 COMANDO A DISTANZA REMOTE CONTROL | |
| 243+ | 270.2690.042 F C | 10 | 1 coperchio/cover | |
| 244+ | 9.9790.003 F C | 10 | 1 vite/screw M 4 X 0,7 X 6 | |
| 245+ | 2760.9180.042 S C | 10 | 1 terminale/cable-end | |
| 246+ | 45.6000.016 FV C | 10 | 1 pastiglia/nut | |
| 248+ | 9.3240.019 FV C | 10 | 1 dado/nut | |
| 249+ | 270.5680.025 SV C | 10 | 1 molla/spring | |
| 250+ | 9.1165.001 S | 10 | 1 anello/circlip | |
| 251+ | 9.3240.004 FV C | 10 | 1 dado/nut | |
| 252+ | 90.6330.057 F C | 10 | 1 piastrina/safety plate | |
| 253+ | 9.3200.015 FVIC | 10 | 1 dado/nut | |
| 254+ | 9.7626.054 S AC | 10 | 2 rondella/washer | |
| 255+ | 9.7625.019 S | 10 | 1 rondella/washer | |

| FIG. NO. | MATRICOLA P.NO | Q.TA Q.TY | NOTE REMARKS | GR. - 4 PAG.09 |
|----------------------|----------------|-----------|--------------|---|
| 256+ | 9.9790.037 | FV C 10 | 2 | vite/screw M 6 X 1 X 8 |
| 257 | | | | |
| 258+ | 283.5200.159 | F AC 10 | 1 | leva/lever |
| 259+249+250+251+252+ | | | | COMANDO A MANO |
| 253+254+255+256+258+ | | | | HAND CONTROL |
| 262+263+264+265+266 | | | | |
| 267+268+270+271+272+ | | | | |
| 273+274+275+277+329+ | | | | |
| 436- | | | | |
| | =273.2515.029 | F C | 1 | |
| 259+ | 283.2690.122 | F AC 10 | 1 | coperchio/cover std. |
| 260 | 9.1760.005 | FV 10 | 2 | bullone/bolt M 6 X 1 X 16 |
| 261 | 9.7625.059 | D C 10 | 2 | rondella/washer |
| 262+ | 283.6370.114 | S AC 10 | 1 | piastra/plate |
| 263+ | 270.9820.073 | D BC 10 | 1 | vite/screw |
| " | 272.9820.109 | D AC 10 | 1 | " |
| 264+ | 9.7625.007 | S C 10 | 1 | rondella/washer |
| 265+ | | | | vedi/see fig.No. 277+... |
| 266+ | 270.5200.086 | S BC 10 | 1 | leva/lever |
| " | 272.5200.254 | D AC | 1 | " |
| 267+ | 9.1770.042 | D C 10 | 1 | bullone/bolt M 8 X 1,25 X 10 |
| 268+ | 9.7555.007 | DV C 10 | 1 | rondella/washer |
| 269 | 9.9800.061 | F C 10 | 3 | vite/screw M 6 X 1 X 16 |
| 270+ | 270.9245.031 | S C 10 | 1 | tirante/tie rod |
| 271+ | 270.7865.018 | D BC | 1 | scatola/housing |
| " | 272.7865.088 | D AC | 1 | " |
| 272+ | 9.3240.008 | FV 10 | 1 | dado/nut |
| 273+ | 9.1760.029 | D A 10 | 1 | bullone/bolt M 6 X 1 X 30 |
| 274+ | 9.3240.008 | FV 10 | 1 | dado/nut |
| 275+ | 9.1760.029 | D C 10 | 1 | bullone/bolt M 6 X 1 X 30 |
| 276+ | 270.4700.069 | N 50 | 1 | guarnizione/joint |
| 277+265+329= | | | | |
| | =283.5200.292 | S C | 1 | LEVA COMPLETA/LEVER ASS.Y std. |
| 277+ | 272.5204.023 | N | 1 | solo per gr.elettrog./only for gen.sets |
| 278 | 9.3021.029 | FVIC | 1 | cuscinetto/ball bearing |
| 279+ | 270.4535.013 | FV C 10 | 1 | guarnizione/joint |
| 280 | 270.5168.005 | D C 10 | 1 | lamierino/tabwasher |
| 281+ | 270.4535.013 | FV C 10 | 1 | guarnizione/joint |
| 282 | 270.4840.008 | FV C | 1 | guida/guide |
| 283+ | 270.6850.024 | SV C | 2 | prigioniero/stud |
| 284 | 292.4740.017 | FV C 10 | 1 | guarnizione/joint |
| 285 | | | | |
| 286 | 9.9730.028 | F 10 | 2 | vite/screw M 8 X 1,25 X 30 |
| 287 | 272.2380.010 | FV C | 1 | cilindro/cylinder 4LD640-640/L |
| " | 279.2380.055 | FV C | 1 | " " 4LD705 |
| " | 291.2380.082 | FV C | 1 | " " 4LD820-820/L |
| 288+ | 272.4410.061 | D A 50 | 1 | guarnizione/joint 4LD640-640/L |
| " | 279.4410.062 | D A 50 | 1 | " " 4LD705 |
| " | 291.4410.063 | D A 50 | 1 | " " 4LD820-820/L |
| 289+292+297+300+302= | | | | ALBERO GOMITO/CRANKSHAFT |
| | =270.1050.005 | F C | 1 | autotraz./automot. 4LD640-640/L-705 |
| | =291.1051.012 | F C | 1 | " " 4LD820-820/L |
| 290 | 270.5065.012 | F C | 1 | lamiera/airtight plate |
| 291 | 270.9245.025 | S C 10 | 1 | tirante/tie rod |
| 292+ | 9.2280.049 | FV 10 | 1 | chiavetta/key |

| FIG. NO. | MATRICOLA P.NO | Q.TA Q.TY | NOTE REMARKS | GR. 4 PAG.10 |
|----------------------|----------------------|-----------|--|--------------|
| 293 | 9.7625.005 FV C 10 | 1 | rondella/washer | |
| 294 | 9.3240.003 FV C 10 | 1 | dado/nut | |
| 295 | 9.3240.003 FV C 10 | 1 | dado/nut | |
| 296+292+297+300+302= | | | ALBERO GOMITO industr.& motopompe | |
| | =272.1051.091 F IC | 1 | CRANKSHAFT industr.& pumping units | |
| | =291.1051.092 F IC | 1 | x 4LD640-640/L-705 | |
| 297+ | 9.8990.019 S C 10 | 1 | tappo/plug | |
| 298 | 262.1640.024 FV C | 1 | br.biella/bearing std.4LD640-640/L-705 | |
| " | 262.1640.025 FV CR10 | 1 | " " -0,25 | |
| " | 262.1640.026 FV CR10 | 1 | " " -0,50 | |
| " | 291.1640.045 FV C | 1 | " " std.4LD820-820/L | |
| " | 291.1640.048 F CR | 1 | " " -0,25 | |
| " | 291.1640.049 F CR | 1 | " " -0,50 | |
| 299 | ***** | | | |
| 300+ | 9.8990.002 F C 10 | 1 | tappo/plug | |
| 301+ | 9.3203.034 FVIC 10 | 2 | dado/nut | |
| 302+ | 9.2280.056 FV C 10 | 1 | chiavetta/key | |
| 303+ | 270.4700.008 FV C 50 | 1 | guarnizione/joint 0,30 | |
| " | 279.4700.074 N 50 | 1 | " " 0,10 | |
| 304+ | 9.6800.059 D 10 | 1 | prigioniero/stud M 10 X 30 (39) | |
| 305+ | 9.6800.018 D 10 | 2 | x 4LD820-820/L - M 10 X 32 (47) & avv.elettrico/electric starting | |
| 306 | 9.7565.011 F C 10 | 6 | rondella/washer | |
| 307 | 9.3240.033 FV 10 | 6 | dado/nut | |
| 308 | 270.8675.067 F C | 1 | supporto/support | |
| 309 | 9.3240.033 FV 10 | 6 | dado/nut | |
| 310 | 9.7565.011 F C 10 | 6 | rondella/washer | |
| 311 | 291.1862.012 S C | 1 | bullone/bolt | |
| 312 | 9.6800.053 S C 10 | 6 | prigioniero/stud M 10 X 18 (33) | |
| 313 | 2830.2052.022 D I | 1 | camp.autotraz./automot.bell MA | |
| " | 270.2050.060 S | 1 | autotr./autom. MU x 4LD640-705 | |
| " | 291.2052.040 N | 1 | autotr./autom. MU (B) x 4LD820 | |
| " | 2720.2052.004 S | 1 | & industr. x 4LD640-705-820 | |
| 314 | 2910.1862.013 S | 1 | campana/bell industr. SAE 6 1/2 | |
| " | 2790.1862.032 D IC | 1 | bullone/bolt industr. SAE | |
| 315+240= | | | CAMPANA/FLANGING BELL | |
| | =270.2031.096 D I | 1 | autotrazione/automotive MU-ME | |
| | =2720.2032.001 S I | 1 | autotr./autom. MA (4 FORI/HOLES) | |
| | =2790.2031.009 S | 1 | industr. | |
| | =2830.2032.044 S | 1 | industr. SAE 5 | |
| | =2830.2032.049 D I | 1 | industr. SAE 6 | |
| 316 | 2830.5855.002 S | 1 | mozzo/hub | |
| 317+ | 9.1165.001 S 10 | 1 | anello/circlip | |
| 318+ | 9.7625.074 N 10 | 1 | rondella/washer std. | |
| " | 9.7625.089 N 10 | 1 | x gruppi elettrogeni/gen.sets | |
| 319 | 9.7555.001 N 10 | 1 | x gruppi elettrogeni/gen.sets | |
| 320+317+318+321+322+ | | | GRUPPO FORCELLA REGOLATORE | |
| 323+324+325+328+368+ | | | GOVERNOR SPEED YOKE ASS.Y | |
| 369+370+371+372+379+ | | | | |
| 383= | | | | |
| | =270.4882.001 S C | 1 | std. | |

| FIG. NO. | MATRICOLA P.NO | Q.TA Q.TY | NOTE REMARKS | GR. 4 PAG.11 |
|--|----------------------|-----------|---|--------------|
| 320+317+318+319+322+ 323+324+328+368+369+ 370+371+372+383+384+ 484+485+486= | | | GRUPPO FORCELLA REGOLATORE GOVERNOR SPEED YOKE ASS.Y | |
| | =272.4882.019 N | 1 | x gruppi elettr./gen.sets 1500/ | |
| | =291.4882.024 N | 1 | x gruppi elettr./gen.sets 1800/ | |
| | =270.4882.014 N | 1 | x gruppi elettr./gen.sets 3000/ | |
| 320+ | 270.5199.008 S C | 1 | leva/lever | |
| 321+ | 270.5800.015 D C 10 | 1 | molla/spring std. | |
| 322+ | 9.8420.012 D C 10 | 1 | spina/locating pin | |
| 323+ | 270.6231.037 D AC 10 | 1 | perno/pin | |
| 324+ | 270.6140.013 D C 10 | 1 | perno/pin | |
| 325+ | 270.3945.027 S C | 1 | forcella/yoke std. | |
| 326 | 9.1760.012 D C 10 | 1 | bullone/bolt M 6 X 1 X 35 | |
| 327 | 9.7540.004 D C 10 | 1 | rondella/washer | |
| 328+ | 270.8615.020 D C | 1 | supporto/support | |
| 329+ | 9.0420.012 D C 10 | 1 | spina/locating pin | |
| 330 | 270.7700.014 D C 10 | 1 | rondella/washer | |
| 331 | 270.9320.046 S C | 1 | tubo/pipe | |
| 332 | 9.9730.010 S 10 | 2 | vite/screw M 6 X 1 X 16 | |
| 333+213+283+304+305+ 334+335+336+338+340+ 341+348+366+406+407+ 407+410+411+414+415+ 416= | | | BASAMENTO COMPLETO predisposto pompa alim. CRANKCASE preset for fuel pump | |
| | =272.1511.069 D IC | 1 | x 4LD640-640/L | |
| | =279.1511.081 S IC | 1 | x 4LD705 | |
| | =291.1512.004 D IC | 1 | x 4LD820-820/L | |
| 334+ | 560.4580.047 FVIC 10 | 1 | guarnizione/joint 1,00 | |
| " | 560.4580.049 FV C 10 | 1 | " " 0,50 | |
| " | 560.4580.050 FV C 10 | 1 | " " 0,80 | |
| 335+ | 9.8430.055 S IC 10 | 1 | spina/locking needle | |
| 336+ | 270.4730.021 SV C 10 | 1 | guarnizione/joint | |
| 337 | 270.1610.009 FV C | 1 | bronz.l.distr./gear side bear. std. | |
| " | 270.1610.058 FV CR10 | 1 | " " -0,50 | |
| " | 270.1610.010 F CR | 1 | " " -1,00 | |
| 338+336+340+341+410+ 414+415+416= | | | FLANGIA FILTRO OLIO ESTERNO FLANGE FOR EXTERNAL OIL FILTER | |
| | =270.3901.041 S C | 1 | | |
| 339 | 9.1901.054 FVIC 10 | 1 | bullone raccordo/connection bolt | |
| 340+ | 9.4670.058 FV C 10 | 1 | guarnizione/copper joint | |
| 341+ | 9.1770.001 FV 10 | 1 | bullone/bolt M 8 X 1,25 X 12 | |
| 342 | 9.4670.058 FV C 10 | 1 | guarnizione/copper joint | |
| 343 | 2790.9455.036 S C | 1 | tubo lubr./lub.pipe | |
| 344 | 9.4670.058 FV C 10 | 1 | guarnizione/copper joint | |
| 345+ | 710.4500.097 FV C 10 | 2 | guarnizione/joint | |
| 346 | 2790.2941.002 F C | 1 | curva/elbow 4LD820 | |
| " | 2790.2942.036 S C | 1 | curva/elbow 4LD640/L-820/L | |
| 347 | 272.1610.025 FV C | 1 | bronz.l.volano/flywh.side bear. std. | |
| " | 272.1610.057 FV CR10 | 1 | " " -0,50 | |
| " | 272.1610.026 F CR | 1 | " " -1,00 | |
| 348+ | 9.6800.010 S C 10 | 5 | x 4LD640-640/L-705 - M 10 X 25 (40) | |
| " | 9.6800.010 S C 10 | 3 | x 4LD820-820/L - M 10 X 25 (40) | |
| 349 | 9.1210.078 FV C 10 | 1 | anello tenuta/seal ring std. | |
| " | 9.1210.083 FV CR10 | 1 | " " -1,00 | |
| 350 | 9.1770.006 S 10 | 2 | bullone/bolt M 8 X 1,25 X 25 | |

| FIG. NO. | MATRICOLA P.NO | Q.TA Q.TY | NOTE REMARKS | GR. 4 PAG.12 |
|------------------|----------------|-----------|---|-----------------|
| 351 | 276.4500.079 | FV C 10 | 1 guarnizione/joint | |
| 352 | 9.7565.007 | F C 10 | 2 rondella/washer | |
| 353 | 9.3240.019 | FV C 10 | 2 dado/nut | |
| 354 | 272.2568.054 | D C | 1 convogliatore/shroud | |
| 355 | 2790.9884.045 | N | 1 volano avv.manov./handle start.flywheel | |
| 356 | 272.2568.045 | D C | 1 convogliatore/shroud | |
| 357 | 9.1585.058 | S A | 2 boccolo/bushing | |
| 358 | 272.2920.072 | D C | 1 cuffia/hood | |
| 359 | 9.8430.051 | D B 10 | 1 spina/locking needle | |
| " | 9.8430.019 | D A 10 | 1 | |
| 360 | 5000.8965.031 | D A | 1 tappo/plug | |
| 361 | 9.1202.016 | SVAC 10 | 1 anello OR/rubber oil seal | |
| 362 | 271.7500.018 | SV C 10 | 3 rondella/washer | |
| 363 | 9.9790.010 | D 10 | 3 vite/screw M 5 X 0,8 X 10 | |
| 364 | 9.3240.033 | FV 10 | 6 dado/nut | |
| 365 | 9.7565.011 | F C 10 | 6 rondella/washer | |
| 366+ | 9.6800.004 | F 10 | 6 prigioniero/stud M 10 X 20 (35) | |
| 367 | 9.1213.058 | FVIC 10 | 1 anello tenuta/seal ring | |
| 368+ | 9.1755.002 | D 10 | 1 bullone/bolt M 5 X 0,8 X 12 | |
| 369+ | 9.1755.004 | D C 10 | 1 bullone/bolt M 5 X 0,8 X 18 | |
| 370+ | 285.6330.061 | D 10 | 1 piastrina/safety plate | |
| 371+ | 270.5655.005 | FV C 10 | 1 molla/spring std.& gr.el./gen.sets 3000/' | |
| " | 272.5655.051 | N 10 | 1 x gruppi elettrog./gen.sets 1500/' | |
| " | 2720.5655.067 | N 10 | 1 x gruppi elettrog./gen.sets 1800/' | |
| 372+ | 270.1557.021 | D C 10 | 1 blocchetto/spacer | |
| 373 | 9.1750.035 | S C 10 | 2 bullone/bolt M 4 X 0,7 X 12 | |
| 374 | 270.6275.038 | DV C 10 | 1 piastra/plate | |
| 375 | 270.6370.038 | D C 10 | 1 piastrina/safety plate | |
| 376 | 270.4935.068 | F C | 1 ingranaggio/gearwheel | |
| 377 | 9.8245.011 | F C 10 | 6 sfera/ball | |
| 378 | 9.1240.006 | FV C 10 | 1 anello seeger/snap ring | |
| 379+ | 270.5655.005 | FV C 10 | 1 molla/spring std.& gr.el./gen.sets 3000/' | |
| 380 | 270.2085.029 | F | 1 campana regol./governor bell | |
| 381 | 270.7700.069 | S C 10 | 1 rondella/washer | |
| 382 | 271.6130.016 | S C | 1 perno/governor shaft | |
| 383+ | 9.1165.006 | D C 10 | 1 anello/circlip | |
| 384 | 9.9800.013 | S C 10 | 1 vite/screw std. M 6 X 1 X 35 | |
| " | 9.9800.049 | N 10 | 1 x gruppi elettr./gen.sets M 4 X 14 | |
| 385 | 9.7625.019 | S 10 | 1 rondella/washer | |
| 386 | 9.3240.033 | FV 10 | 1 dado/nut | |
| 387 | 9.3203.014 | FV C 10 | 1 dado/nut | |
| 388+ | 9.9765.001 | S C 10 | 1 vite/screw M 6 X 1 X 8 | |
| 389 | 9.7625.010 | FV C 10 | 1 rondella/washer | |
| 390 | 9.9730.030 | S C 10 | 2 vite/screw M 8 X 1,25 X 35 | |
| 391 | 272.4975.018 | F IC | 1 ingranaggio/gearwheel | |
| 392 | 9.7565.007 | F C 10 | 2 rondella/washer | |
| 393+388+394+395= | =272.4336.023 | F IC | GRUPPO POMPA OLIO LUB. PUMP OIL ASS.Y | |
| 394+ | | | vedi/see fig.No. 393+... | |
| 395+ | | | vedi/see fig.No. 393+... | |
| 396 | 9.9730.015 | F C 10 | 1 vite/screw M 6 X 1 X 30 | |
| 397 | 9.7565.004 | F C 10 | 1 rondella/washer | |
| 398 | 9.7625.007 | S C 10 | 1 rondella/washer | |
| 399 | 9.2200.001 | F C 10 | 1 chiavetta/key | |
| 400 | 270.6645.040 | S C | 1 portina/oil pan | |
| 401 | 9.7625.010 | FV C 10 | 10 rondella/washer | |
| 402 | 9.1770.002 | FV 10 | 10 bullone/bolt M 8 X 1,25 X 16 | |
| 403+ | 270.4600.091 | FV C 10 | 1 guarnizione/joint | |
| 404 | 9.4670.016 | FV C 10 | 1 guarnizione/copper joint | |

| FIG. NO. | MATRICOLA P.NO | Q.TA Q.TY | NOTE REMARKS | GR. 4 PAG.13 |
|----------------|----------------|-----------|---|--------------|
| 405 | 9.8965.005 | FV C 10 | 1 tappo/oil drain plug | |
| 406+ | 255.6700.012 | S C | 1 portina/pan | |
| 407+ | 9.6780.012 | DV C 10 | 2 prigioniero/stud M 8 X 25 (37) | |
| 408 | 9.7565.011 | F C 10 | 8 rondella/washer | |
| 409+ | 9.7555.007 | DV C 10 | 2 rondella/washer | |
| 410+ | 9.7555.007 | DV C 10 | 2 rondella/washer | |
| 411+ | 9.3240.018 | FV 10 | 2 dado/nut | |
| 412 | 9.1780.005 | FV 10 | 8 bullone/bolt M 10 X 1,5 X 28 | |
| 413 | 270.6426.010 | D C | 2 piede/engine mount | |
| 414+ | 9.1770.007 | F C 10 | 2 bullone/bull M 8 X 1,25 X 30 | |
| 415+ | 9.4670.060 | FV C 10 | 1 guarnizione/copper joint | |
| 416+ | 9.8965.003 | FV C 10 | 1 tappo/plug | |
| 417 | 9.3630.037 | D C | 1 fascetta/clamp | |
| 418 | 710.5401.011 | D C 10 | 1 manicotto/rubber sheating | |
| 419 | 9.1901.055 | FVIC 10 | 1 bullone raccordo/connection bolt | |
| 420 | 9.4670.058 | FV C 10 | 1 guarnizione/copper joint | |
| 421 | 9.4670.058 | FV C 10 | 1 guarnizione/copper joint | |
| 422 | 2790.8545.040 | D | 1 staffa/brace 4LD640-705-820 | |
| " | 2790.8545.091 | S C | 1 staffa/brace 4LD640/L-820/L | |
| 423 | 270.5460.090 | F C | 1 marmitta/muffler std. | |
| " | 2830.5461.090 | F C | 1 x avv.elettrico/electric starting | |
| 424+459+460= | | | PRESSOSTATO COMPLETO | |
| =9040.6745.031 | FVAC | 1 | OIL PRESSURE SWITCH | |
| 425+426= | | | FILTRO OLIO COMPLETO | |
| =270.3740.024 | FV C | 1 | OIL FILTER | |
| 426+ | 270.2175.028 | FV C | 1 cartuccia olio/oil filter element | |
| 427 | 9.7565.011 | F C 10 | 2 rondella/washer | |
| 428 | 9.1780.007 | S 10 | 2 bullone/bolt M 10 X 1,5 X 35 | |
| 429 | 9.1780.031 | FV 10 | 1 bullone/bolt M 10 X 1,5 X 25 | |
| 430 | 9.3240.033 | FV 10 | 1 dado/nut | |
| 431 | 9.7565.011 | F C 10 | 1 rondella/washer | |
| 432 | 2910.9170.028 | F C | 1 terminale/muffler end | |
| 433 | 2830.5461.047 | F C | 1 marmitta/muffler | |
| 434 | 9.6800.020 | F 10 | 6 prigioniero/stud M 10 X 35 (50) | |
| 435 | 90.8460.083 | D 10 | 2 spina/taper pin | |
| 436 | 9.7565.007 | F C 10 | 8 rondella/washer | |
| 437 | 9.1770.014 | D C 10 | 8 bullone/bolt M 8 X 1,25 X 45 | |
| 438 | 2790.6480.029 | D | 1 pianone/pinion gear | |
| 439 | 9.7565.007 | F C 10 | 6 rondella/washer | |
| 440 | 9.9730.026 | F 10 | 6 vite/screw M 8 X 1,25 X 20 | |
| 441 | 272.4970.008 | D B | 1 ingranaggio/gearwheel | |
| " | 2790.4970.014 | S A | 1 | |
| 442 | 2790.3835.061 | D BC | 1 flangia/flange | |
| " | 2790.7885.019 | D A | 1 scatola/housing | |
| 443 | 9.7565.007 | F C 10 | 4 rondella/washer | |
| 444 | 270.5800.071 | F BC 10 | 1 molla/spring | |
| " | 7150.5801.028 | S A | 4 | |
| 445 | 9.1770.007 | F C 10 | 1 bullone/bolt M 8 X 1,25 X 30 | |
| 446 | 270.5455.006 | S | 1 manovella/starting hand-crank | |
| 447 | 500.7980.044 | D BC | 1 scodellino/cup | |
| " | 500.7980.045 | S A | 1 | |
| 448 | 9.1240.046 | D B 10 | 1 anello seeger/snap ring | |
| " | 9.1240.041 | D A 10 | 1 | |
| 449 | 203.4055.003 | F C | 1 fune avviamento/rope starting | |
| 450 | 291.6371.039 | F C | 1 piastra avv.elett./electric start.plate | |

| FIG. NO. | MATRICOLA P. NO | Q.TA Q.TY | NOTE REMARKS | GR. 4 PAG. 14 |
|----------|-----------------|-----------|--------------|---|
| 451 | 272.4730.107 | SVAC 10 | 1 | guarn./head joint 0,70 4LD640-640/L |
| " | 272.4730.108 | SVAC 10 | 1 | " " 0,80 " " |
| " | 272.4730.109 | DVAC 10 | 1 | " " 0,90 " " |
| " | 272.4730.110 | DVAC 10 | 1 | " " 1,00 " " |
| " | 272.4730.111 | DVAC 10 | 1 | " " 1,10 " " |
| " | 279.4730.112 | S A 50 | 1 | " " 0,70 4LD705-820-820/L |
| " | 279.4730.113 | S A 50 | 1 | " " 0,80 " " |
| " | 279.4730.114 | S A 50 | 1 | " " 0,90 " " |
| " | 279.4730.115 | S A 50 | 1 | " " 1,00 " " |
| " | 279.4730.116 | S A 50 | 1 | " " 1,10 " " |
| 452+456= | =2830.3730.036 | FV C | 1 | FILTRO COMBUSTIBILE ESTERNO EXTERNAL FUEL FILTER |
| 453 | 9.4670.016 | FV C 10 | 2 | guarnizione/copper joint |
| 454 | 9.4670.016 | FV C 10 | 2 | guarnizione/copper joint |
| 455 | 9.1901.032 | FVIC 10 | 2 | bullone raccordo/connection bolt |
| 456+ | 2830.2175.045 | FVAC | 1 | cartuccia comb./f.filter element |
| 457 | 9.7625.019 | S | 10 | 6 rondella/washer |
| 458+ | 9.1200.041 | FV | 10 | 1 anello OR/rubber oil seal |
| 459+ | 3600.6491.013 | FVAC | 1 | 1 pipetta/pipe elbow |
| 460+ | 5000.9180.056 | FVAC 10 | 1 | 1 terminale/gaston |
| 461 | 9040.2900.069 | F C | 1 | 1 cruscotto/dashboard |
| 462 | 9040.2900.070 | F C | 1 | 1 dashboard |
| 463 | 9040.6612.063 | S AC | 1 | 1 spia olio/oil warning |
| 464 | 9040.6612.064 | S AC | 1 | 1 spia batteria/battery warning |
| 465 | 9040.5175.119 | F AC 10 | 1-2 | 1 lampadina/lamp |
| 466 | 9040.2615.021 | F C | 1 | 1 coperchio/cover |
| 467 | 2830.5040.004 | SV C | 1 | 1 interruttore/key switch |
| " | 2760.5041.020 | FV C | 1 | " " " Bosch |
| 468 | 2760.2750.111 | F C | 1 | 1 coperchio/switch cover |
| 469 | 2760.5450.009 | FV C | 1 | 1 manometro olio/pressure gauge |
| 470 | 2790.8506.010 | D C | 1 | 1 squadretta/angle bracket |
| 471 | 2790.8506.011 | N | 1 | 1 squadretta/angle bracket |
| 472 | 2790.8506.012 | N | 1 | 1 squadretta/angle bracket |
| 473 | 2790.8506.038 | N | 1 | 1 squadretta/angle bracket |
| 474 | 273.7300.057 | FV C 10 | 1 | 1 raccordo/connection |
| 475 | 9.3630.008 | F C 10 | 1 | 1 fascetta/clamp |
| 476 | 2920.7362.158 | S C | 1 | 1 regol.gr.elettrog./gen.sets governor |
| 477 | 9.1240.005 | DV C 10 | 1 | 1 anello seeger/snap ring |
| 478 | 270.4894.003 | N | 1 | 1 campana reg.gr.elettr./gen.sets ball |
| 479 | 270.6130.036 | D C | 1 | 1 perno gr.elettr./gen.sets shaft |
| 480 | 9.1760.005 | FV | 10 | 1 bullone/bolt M 6 X 1 X 16 |
| 481 | 9.7701.014 | D C 10 | 1 | 1 rondella/washer |
| 482 | 9.8400.056 | D C 10 | 1 | 1 spina/taper pin |
| 483 | 270.6371.081 | N | 10 | 1 piastra/plate |
| 484+ | 9.3030.051 | S | 2 | 2 cuscin.gr.elettrog./gen.sets ball bear. |
| 485+ | 270.8785.040 | D C | 1 | 1 supp.gr.elettrog./gen.sets support |
| 486+ | 270.5202.007 | N | 10 | 1 leva gr.elettrog./gen.sets lever |

| FIG. NO. | MATRICOLA P.NO | Q.TA Q.TY | NOTE REMARKS | GR. 4 PAG.15 |
|---|---------------------|-----------|---|--------------|
| 487 | 2830.8760.037 S IC | 1 | supporto/support | |
| 488+ | | | vedi/see fig. 9+.../94+... | |
| 489+ | 292.5496.110 SVAC | 1 | massa filtrante/upper filtering element | |
| 490 | 9.3203.059 N | 10 2 | dado/nut | |
| 89+150+162+202+227+ 242+276+279+281+288+ 303+334+336+345+403+ 451= | | | SERIE GUARNIZIONI GASKET SET | |
| | =272.8180.024 FV CR | 1 | x 4LD640-640/L | |
| | =279.8180.027 FV CR | 1 | x 4LD705 | |
| | =291.8180.038 FV CR | 1 | x 4LD820-820/L | |

DISVI/RICA

01.01.1986

DESCRIZIONI NON IMPEGNATIVE
SUBJECT TO MODIFICATIONS

aggiornata al 21.11.1986

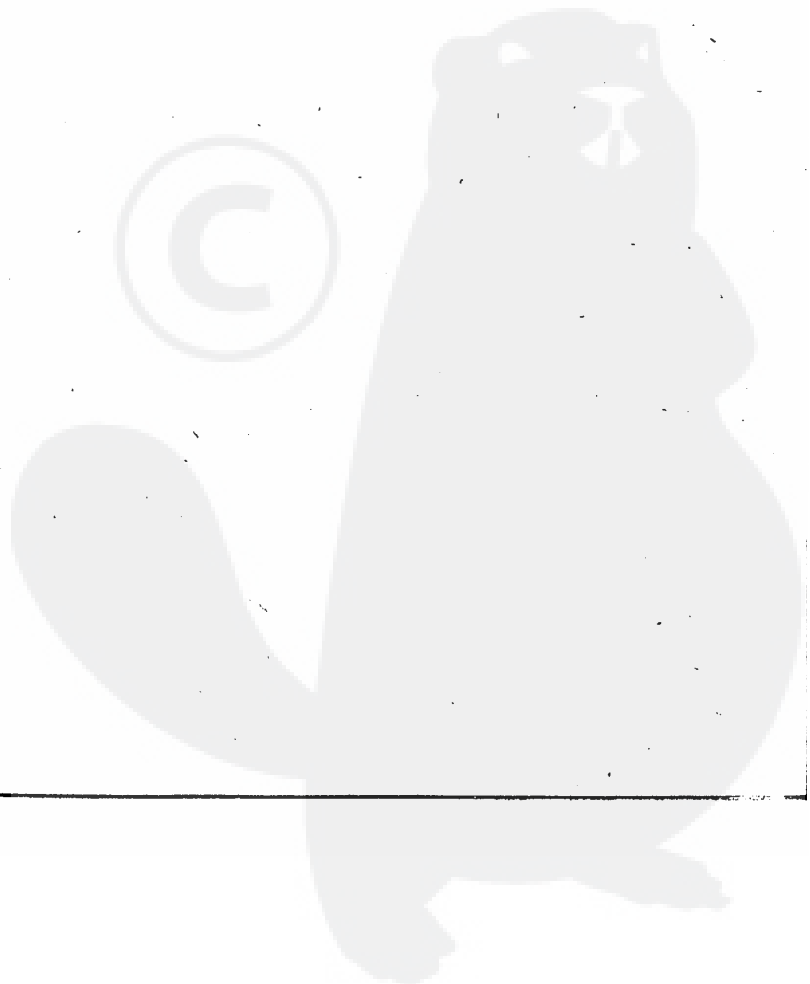

MATERIALE DI RETTIFICA
GRINDING WORKSHOP PARTS LIST
MATERIEL POUR RECTIFIEUR

GR. 04
PAG.16

MOTORI-ENGINES-MOTEURS GR. 4

| FIG. NO. | MATRICOLA PART NO. | Q.TA Q.TY | NOTE REMARKS |
|---|----------------------|-----------|--|
| 97+ | 291.9652.019 FV CR10 | 1 | valvola aspirazione/inlet valve |
| 98+ | 291.9685.031 FV CR10 | 1 | valvola scarico/exhaust valve |
| 158+ | 291.4845.054 FV CR10 | 1 | guida v.aspir./inlet v.guide std. |
| " | 291.4845.060 FV CR10 | 1 | " " +0,50 |
| 161+ | 291.4845.055 FV CR10 | 1 | guida v.scar./exhaust v.guide std. |
| " | 291.4845.061 FV CR10 | 1 | " " +0,50 |
| 174+175+176+177= | | | PISTONE COMPLETO/PISTON SET |
| | =272.6500.071 F CR | 1 | +0,50 x 4LD640-640/L |
| | =272.6500.072 F CR | 1 | +1,00 |
| | =279.6501.022 F CR | 1 | +0,50 x 4LD705 |
| | =279.6501.023 F CR | 1 | +1,00 |
| | =291.6501.071 F CR | 1 | +0,50 x 4LD820-820/L |
| | =291.6501.072 F CR | 1 | +1,00 |
| 175+ | 276.8210.053 F CR10 | 1 | serie segm./ring set +0,50 4LD640-640/L |
| " | 276.8210.054 F CR10 | 1 | " " +1,00 |
| " | 279.8210.050 F CR10 | 1 | " " +0,50 4LD705 |
| " | 279.8210.051 F CR10 | 1 | " " +1,00 |
| " | 291.8210.059 F CR10 | 1 | " " +0,50 4LD820-820/L |
| " | 291.8210.060 F CR10 | 1 | " " +1,00 |
| 211+ | 291.8000.046 FV CR10 | 1 | sede v.aspirazione/inlet v.seat |
| 212+ | 291.8000.047 FV CR10 | 1 | sede v.scarico/exhaust v.seat |
| 215+ | 270.1630.006 FV CR10 | 1 | bronz.piede biella/small end bearing |
| 298 | 262.1640.025 FV CR10 | 1 | br.biella/bearing -0,25 4LD640-640/L-705 |
| " | 262.1640.026 FV CR10 | 1 | " " -0,50 |
| " | 291.1640.048 F CR | 1 | " " -0,25 4LD820-820/L |
| " | 291.1640.049 F CR | 1 | " " -0,50 |
| 337 | 270.1610.058 FV CR10 | 1 | bronz.l.distr./gear side bear. -0,50 |
| " | 270.1610.010 F CR | 1 | " " -1,00 |
| 347 | 272.1610.057 FV CR10 | 1 | bronz.l.volano/flywh.side bear.-0,50 |
| " | 272.1610.026 F CR | 1 | " " -1,00 |
| 349 | 9.1210.083 FV CR10 | 1 | anello tenuta/seal ring -1,00 |
| 89+150+162+202+227+ 242+276+279+281+288+ 303+334+336+345+403+ 451= | | | SERIE GUARNIZIONI GASKET SET |
| | =272.8180.024 FV CR | 1 | x 4LD640-640/L |
| | =279.8180.027 FV CR | 1 | x 4LD705 |
| | =291.8180.038 FV CR | 1 | x 4LD820-820/L |